



CONFERENCES, MEETINGS AND EVENTS...

ROOKERY HALL COMBINES ORIGINAL ARCHITECTURE AND CONTEMPORARY, STYLISH DESIGN TO OFFER A MODERN, FLEXIBLE AND CHARMING VENUE TO MOTIVATE YOUR TEAM, ENGAGE YOUR DELEGATES AND IMPRESS YOUR GUESTS.

Located close to principle roads in the area, this 70 bedroom, 4 AA Red star country house hotel is easily accessed from Manchester, Stoke, Chester and Crewe and is situated just 10 minutes from J16 of the M6.

Situated in 38 acres of Cheshire countryside, close to Nantwich, Rookery Hall offers extensive, flexible and contemporary conference, meeting and event facilities, enhanced by state of the art HDMi compatible technology, integrated AV and complimentary fibre optic WiFi throughout.

The hotel is ideal for a wide variety of events including team building, seminars, training, conferences, meetings, AGMs, annual awards, corporate dinners and product or car launches with vehicular access available.

Contact our team to discuss your requirements, make an enquiry or request a quote on **01270 610016** or email **rookeryhall@handpicked.co.uk** Further information on our meeting and event packages is available on our website **handpickedhotels.co.uk/rookeryhall**.

*Hand*PICKED
HOTELS
BUILT FOR PLEASURE



DAY DELEGATE PACKAGE

The Day Delegate package consists of:

- Meeting room hire
- Unlimited tea and coffee
- Morning and afternoon refreshments
- Working buffet lunch or a hot and cold buffet lunch in the restaurant
- LCD projector and either drop down or TV screen in all meeting rooms
- Integrated AV and HDMI technology in all meeting rooms
- Flipchart, stationery, mineral water and sweets in the meeting room

**Private dining options also available.
See page 9 for further information.**

24 HOUR DELEGATE PACKAGE

The following is included in addition to the Day Delegate package:

- Three course delegate evening meal with coffee (menu selector available)
- Overnight accommodation with full traditional breakfast
- Complimentary use of award-winning health club and spa

Additional benefits:

- Free high speed WiFi throughout conference suites, bedrooms and public areas
- Air conditioning and natural daylight
- Complimentary onsite parking
- HDMI compatible technology with integrated screens and projectors
- E-printer and electronic pack in each room

CHOOSE THE BEST ROOM FOR YOUR MEETING OR EVENT...

At Rookery Hall Hotel we offer a range of stylish and contemporary meeting rooms, purpose built and designed for executive use. You can select the room and desired layout to most suit your business needs.

ROOM LAYOUTS



Boardroom

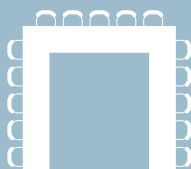

U-Shape

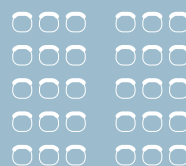

Theatre

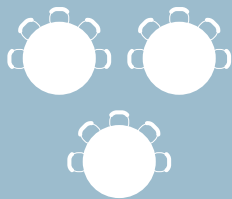

Cabaret



Classroom

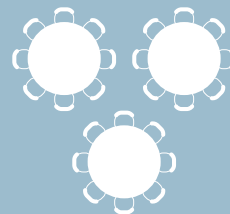

Dining

ROOM CAPACITIES

	Capacity & Configurations							Dimensions (Metres)			Totals		Leisure				
	Max Capacity	Boardroom	U-Shape	Theatre	Cabaret	Classroom	Reception	Dining	Length	Width	Height	Bedrooms	Meeting Rooms	Spa	Health Club	Gym	Pool
Worleston	200	60	50	200	120	90	200	160	15.7	14.8	3.4	70	9	✓	✓	✓	✓
- Calveley	120	36	36	120	50	45	120	80	15.7	7.4	3.4						
- Wardle	120	36	36	120	50	45	120	80	15.7	7.4	3.4						
Wybunbury	120	50	50	100	60	70	120	70	19.1	6.3	2.4						
Audlem	30	18	16	24	20	12	30	20	7.8	4.8	2.4						
Tarvin	60	28	28	60	30	24	60	50	10.6	6.3	2.4						
Tarporley	60	20	20	60	30	24	60	30	8.5	6.3	2.4						
Burland	10	10	8	-	-	-	-	10	4.9	4.9	2.4						
Weaver Bar	100	-	-	-	-	-	100	-	9.9	8.2	3.2						
Morning Room	30	24	16	30	18	20	30	30	7.0	5.0	3.6						

WORLESTON

This room has stunning light quality and views over the countryside highlighted by floor to ceiling windows and a 3.4m ceiling. The rear patio doors lead out onto a paved terrace area and extensive lawns making it ideal for team building events.

Business facilities:

Fibre optic WiFi, HDMI integrated technology, two 3x2 metre drop down screens, ISDN points, multiple power sockets, sound proofing, air-conditioning, touch screen controls, e-printer and a call button for your dedicated conference assistant.

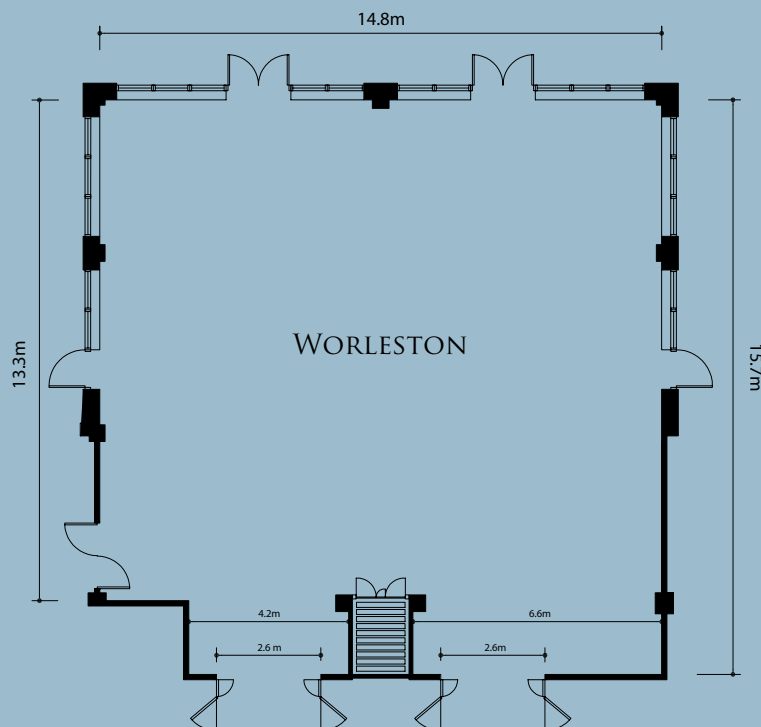

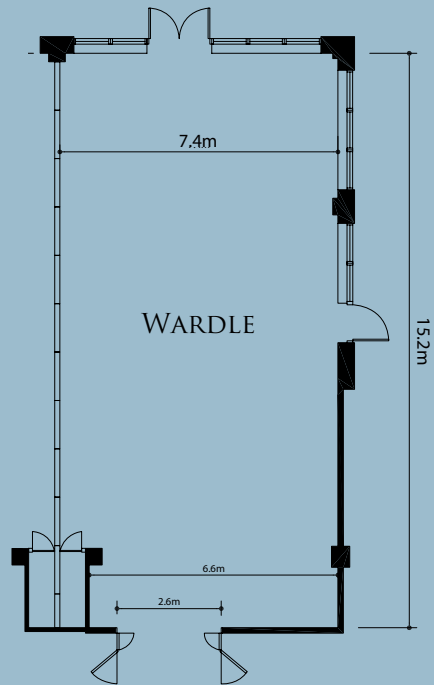
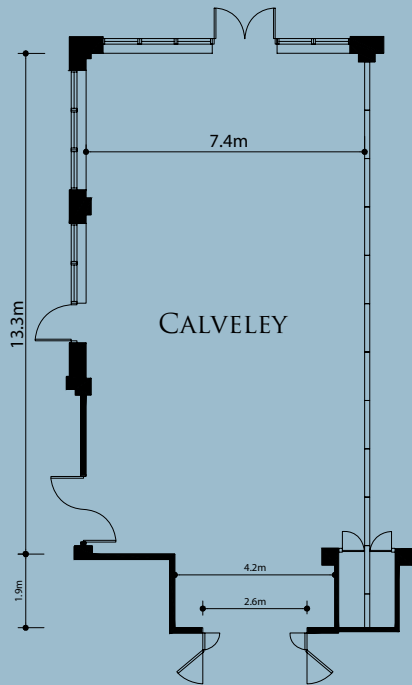

CALVELEY & WARDLE

The Worleston Suite can be split into two rooms by utilising a retractable and soundproofed dividing wall, creating Calverley and Wardle.

Business facilities:

Fibre optic WiFi, HDMI integrated technology, 3x2 metre drop down screen, ISDN points, multiple power sockets, sound proofing, air-conditioning, touch screen controls, e-printer and a call button for your dedicated conference assistant.



WYBUNBURY

Situated on the first floor of the function suite, this modern room is a spacious suite featuring a dark wood design with an LCD TV screen at each end (these can be covered as required). It leads onto an outdoor stone terrace area with views over the grounds.

Business facilities:

LCD 4K 60 inch TV screen, WiFi, ISDN points, HDMI technology, e-printer, sound proofing, air-conditioning and call button for your dedicated conference assistant.

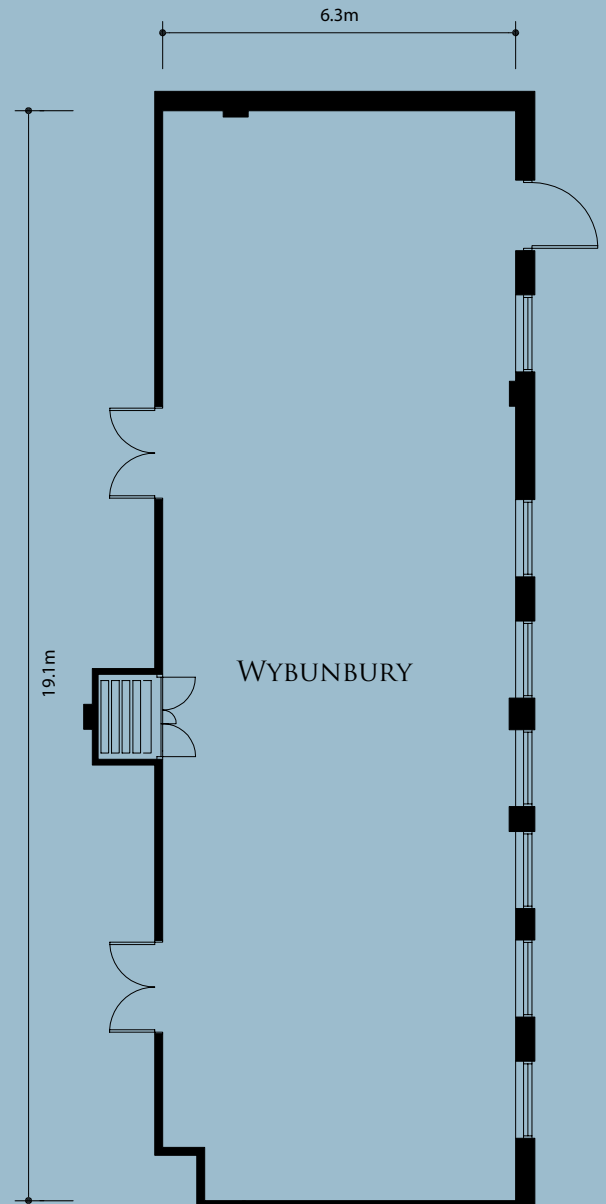

TARVIN & TARPORLEY

These rooms are created when Wybunbury is divided into two and therefore share similar amenities with the exception that Tarpoley has no access directly to the terrace.

Business facilities:

LCD 4K 60 inch TV screen, WiFi, ISDN points, HDMI technology, sound proofing, e-printer, air-conditioning and call button for your dedicated conference assistant.

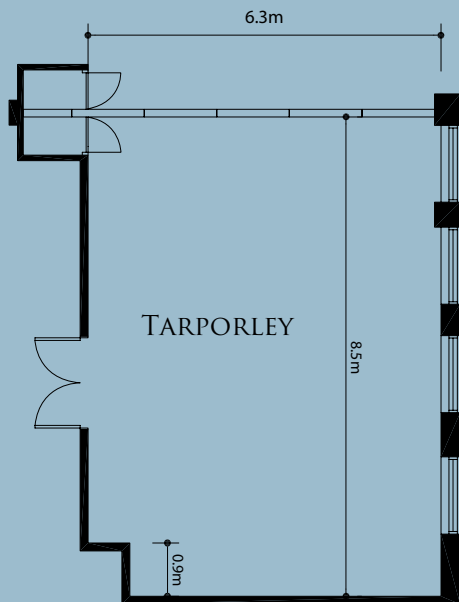
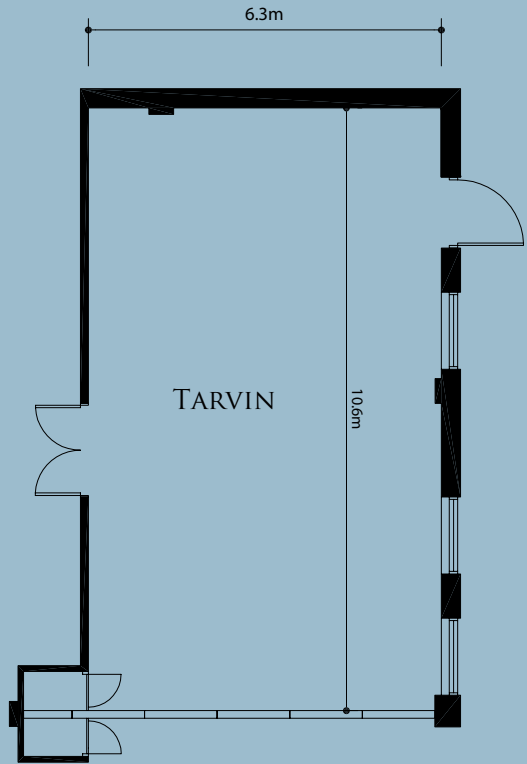

AUDLEM

Again on the first floor this is a boardroom, seating up to 18 people for business or private dining. It has a door leading onto a balcony area.

Business facilities:

LCD 4K 60 inch TV Screen, WiFi, ISDN, air-conditioning and sound proofing and call button for your dedicated conference assistant.

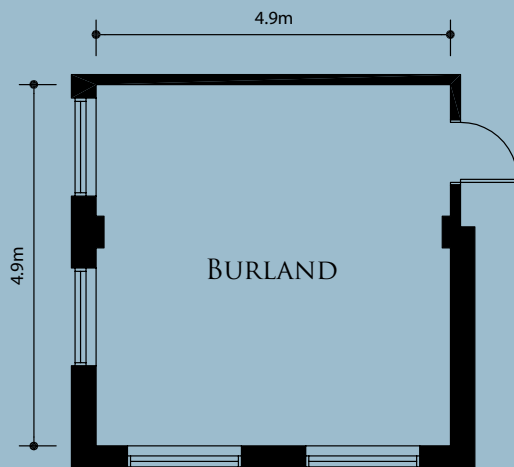
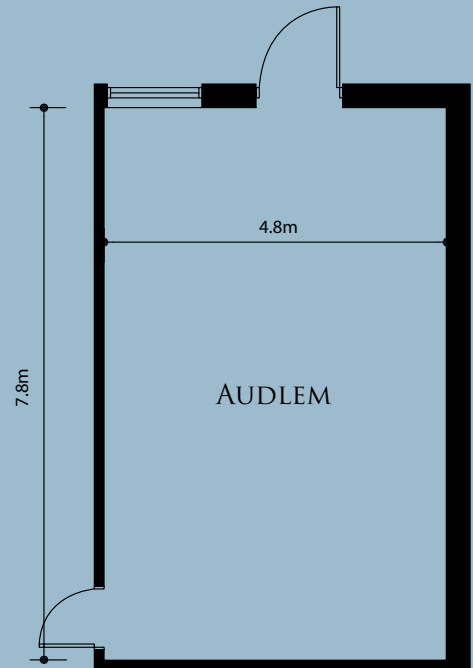

BURLAND

Similar in design to Audlem however this is better suited for up to 10 delegates, with dual aspect windows creating a light and airy room.

Business facilities:

LCD 4K 60 inch TV screen, WiFi, ISDN points, HDMI technology, sound proofing, e-printer, air-conditioning and call button for your dedicated conference assistant.

Please note that rooms on the first floor of the conference area are accessible by stairs and lift. These rooms have a foyer area for refreshments and working lunches as well as access to external terraced areas.

PRIVATE DINING OPTIONS

THE MORNING ROOM IS A PERFECT SETTING FOR BUSINESS ENTERTAINING WITH ITS WOOD PANELLED WALLS, FLOOR TO CEILING WINDOWS AND DIRECT ACCESS TO THE TERRACE AND LAWNS.

We have created an executive private dining package specifically for our business clients. We have considered all the main elements you and your guests will require for an exclusive evening event, whether it is to continue the business discussions of the day, to reward your team or to entertain your key customers this package will ensure a professional and private event for you and your invited guests.

This package is perfect for parties of 10 up to 30 and includes:

- Private use of the Morning Room
- A pre-dinner glass of chilled Champagne
- Pre-dinner canapés
- Three course set menu plus a sorbet course (menu choices to be made from the menu selector)
- Half bottle of house wine per person
- Coffee and petits fours
- Table centre piece/candles
- White linen and napkins
- Direct access to terrace and lawns
- Dedicated service team on the night

Priced from £70 per person

Additional drinks, cocktails, wine and menu choices are available (supplements may apply). We also offer a variety of other private dining rooms, menus and drinks reception options suitable for 10 to 160 guests.



ACCOMMODATION

ROOKERY HALL HAS 70 BEDROOMS WHICH OFFER A VARIETY OF ACCOMMODATION OPTIONS FROM STYLISH CLASSIC ROOMS TO EXECUTIVE ROOMS AND FEATURE SUITES.

Benefits include:

- Flat screen TV and DVD/CD player
- Workstation/desk in each room
- Complimentary WiFi in bedrooms and public areas
- In-room safes, capable of storing laptops
- Air-conditioning in Executive bedrooms
- Unique Hand Picked toiletries
- LCD television in all Executive bathrooms
- Feature suites and period bedrooms are also available in the main house
- Complimentary use of our health club and spa, offering fully equipped state-of-the-art gym, indoor pool, crystal steam room and sauna.

Supplements may apply for some room types.





TEAM BUILDING

LOCATED IN 38 ACRES OF GARDENS AND GROUNDS AND WITH 8 FLEXIBLE MEETING ROOMS, ROOKERY HALL IS PERFECT FOR BOTH INDOOR AND OUTDOOR ACTIVITIES. THE VERSATILE WORLESTON SUITE LEADS DIRECTLY OUT ONTO THE EXTENSIVE TERRACE AND LAWNS WITH OUR LICENSED ACTIVITY FIELD JUST BEYOND.

Favourites include:

- Archery
- Cocktail making
- Falconry
- Duck herding
- Inflatables
- Laser clays/clay pigeon shooting
- Teambuilding challenges
- Treasure hunts
- Wine tasting

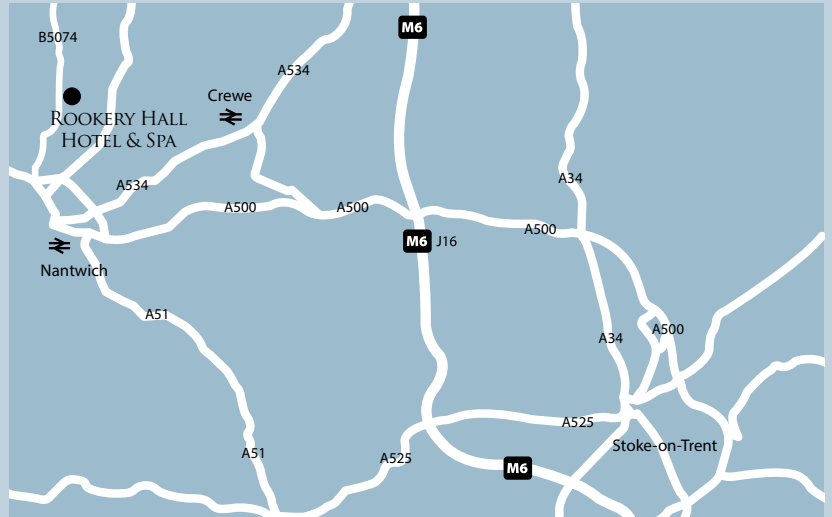

ROOKERY HALL HOTEL & SPA

CONTACT AND LOCATION INFORMATION.

Nearest Motorway Link M6 J16/18

Nearest Airport Manchester 25 miles

Nearest Train Station Crewe 5 miles

Helicopter Grid Reference North 53 05 95 West 02 30 53

HOW TO FIND US...

From Manchester Airport

Take the M56 sign posted Chester. Leave the M56 at Junction 9 and follow signs for the M6 southbound. Leave the M6 at Junction 18. Then follow directions for travelling by car from the North.

From the North

Leave the M6 at Junction 18. Follow signs for Middlewich on the A54, and then take the A530 for Nantwich. Follow this road for 3 miles, passing the Verdin Arms pub. Some 400 yards later, turn right, sign posted Church Minshull. In the village, turn left towards Nantwich on the B5074, passing the Badger Public House. Rookery Hall is located 3.5 miles on the left.

From the South

Leave the M6 at Junction 16 and take the A500 to Nantwich. Follow this road continuing straight over the next 3 roundabouts signposted A500/A51 Chester. At the 4th roundabout, turn right, taking the 3rd exit, still signposted A500/A51 Chester. Continue straight over the next 2 roundabouts (at the second roundabout, you should spot Sainsbury's Superstore on your left). At the final roundabout you should take the third exit, sign posted the B5074, towards Worleston and Winsford. On the B5074 Rookery Hall is 1 mile along this road on the right-hand side.

 facebook.com/rookeryhall  [@rookeryhotel](https://twitter.com/rookeryhotel)

Rookery Hall Hotel & Spa

Main Road, Worleston, Nantwich Cheshire CW5 6DQ

T 01270 610016 F 0845 072 7534

E rookeryhall@handpicked.co.uk

handpickedhotels.co.uk/rookeryhall

*Hand*PICKED
HOTELS
BUILT FOR PLEASURE